

LUXsphere Pro

by LUXTECH

INSTALLATION GUIDE

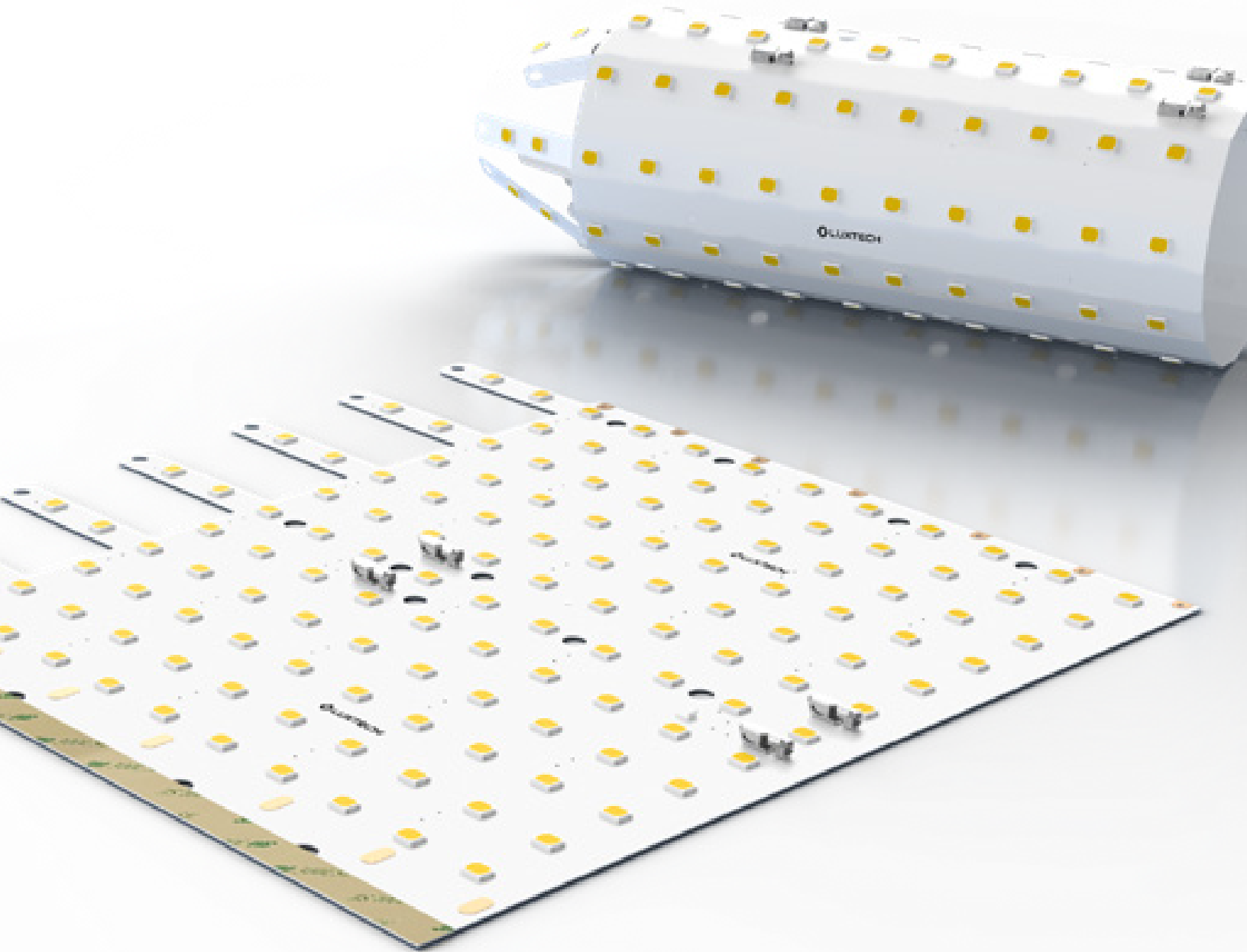

INTRODUCTION

LUXsphere is designed to simplify globe fixture illumination, making installation faster, easier, and more consistent. This guide outlines best practices from LUXTECH to ensure a seamless fit and save assembly time.

Although LUXsphere modules include built-in ESD protection, proper ESD precautions should still be taken to protect the LEDs and ensure long-term reliability.

BEST PRACTICES

Match the LUXsphere module to your globe size for the best results:

- LUXsphere Mini Pro → Small globes (<9" diameter)
- LUXsphere Pro → Medium globes (9–24")
- LUXsphere XL Pro → Large globes (24"+)

Using the right size ensures smooth, even illumination with minimal hotspots.

WHAT'S INCLUDED

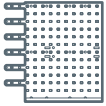

LUXsphere module

CUSTOMER RECOMMENDED PARTS



ESD Strap



Internal Bracket
(information available on website)



Fasteners/Screws
(information available on website)

TOOLING

Ask Luxtech about tooling recommendations to make assembly easier.

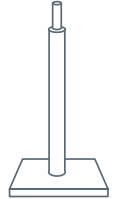

Finger Assembly Jig

INSTALLATION

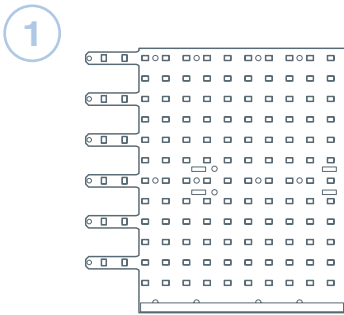

Position the module

Place LUXsphere flat on the table in front of you with the LED side up.

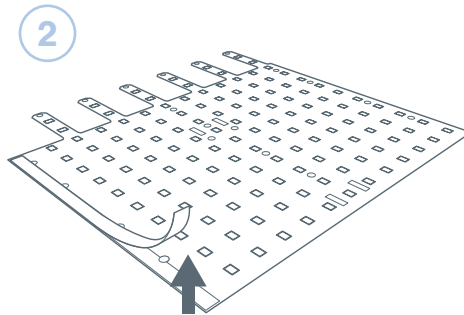

Remove edge tape

Carefully peel away the protective tape along the edge as instructed. Keep fingers away from LED surfaces.

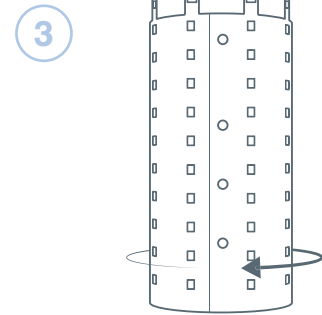

Form the cylinder

With the tape removed, gently curl the sheet into a cylinder. Bring the two ends together and make sure the alignment holes at each end line up perfectly.

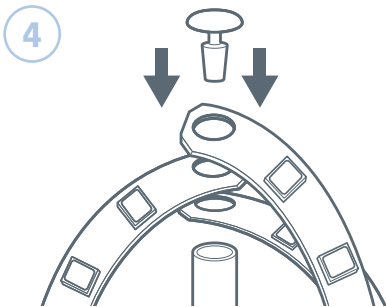

Align fingers

Align the 6 fingers by gently bending them inward until the holes line up. Secure them in place by pushing the plastic rivets through the aligned holes. **(Rivets available on website)**

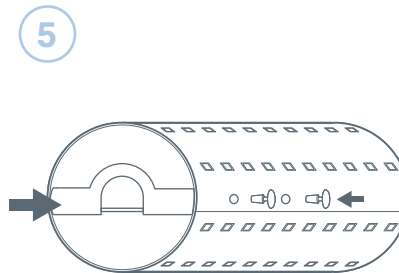

Add bracket

Insert the internal structure bracket into the cylinder and lock it in place using four additional plastic rivets. **(Internal bracket available on website)**

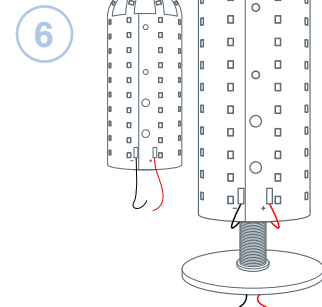

Insert wires & threaded stem

Insert the supply wires into connectors. Route the connected wires through the threaded stem of the manufacturer's light.